

Catharsis

A memorial designed to aid the grieving process by providing a cyclical journey that takes visitors from a busy, colourful, space to a clean space of contemplation and then back again.

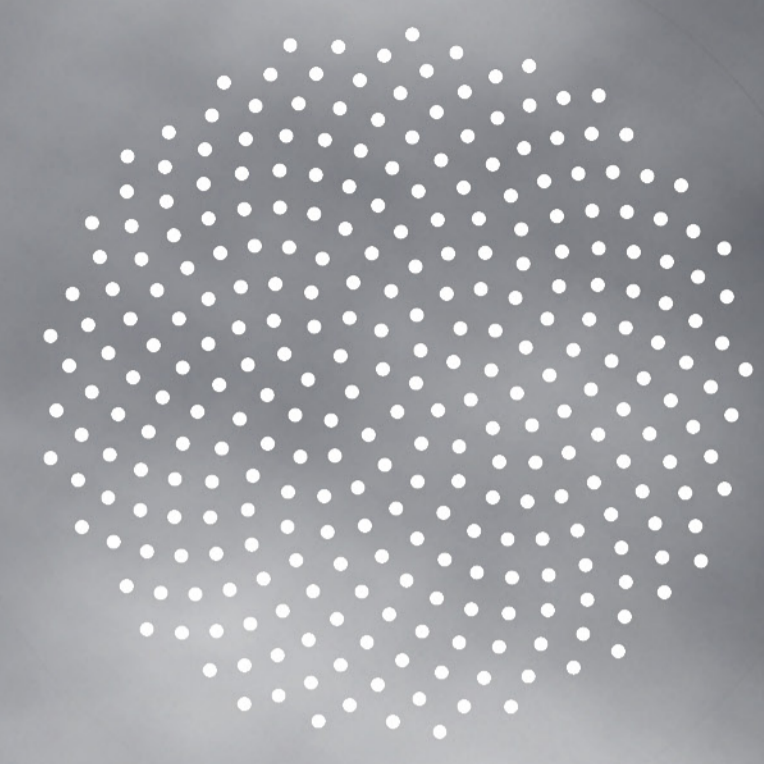

The Memorial Fountain consists of 298 individual jets arranged in a Fibonacci sequence across the 107m wide lake.

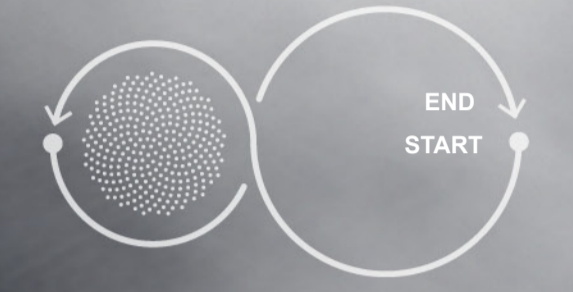
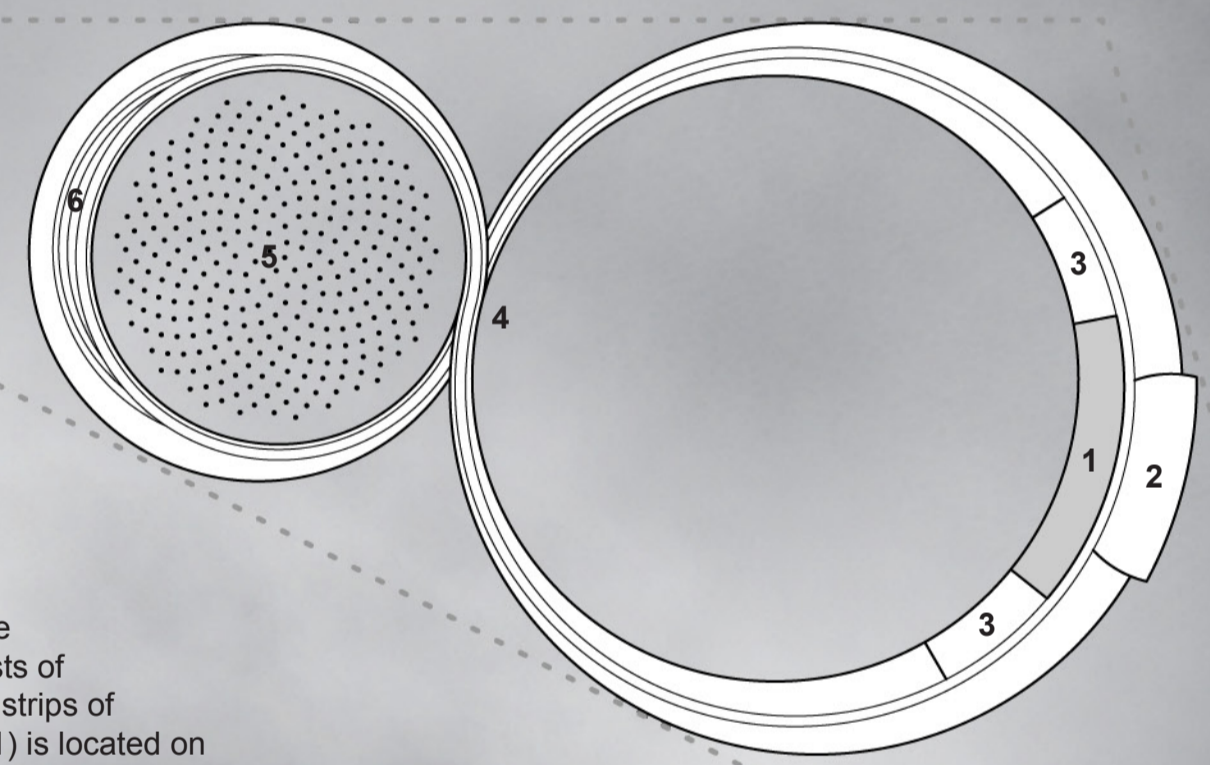

The island sits within the triangular boundary of the competition site. It consists of two lakes surrounded by strips of land. The visitor centre (1) is located on the larger of the two lakes, adjacent to the landing area (2). The topography of the island is sculpted in smooth curves, including those that connect the ground level with the visitor centre roof (3) and form the bridge (4). The smaller lake contains the Memorial Fountain (5) and is the location of the tiered viewing area (6).

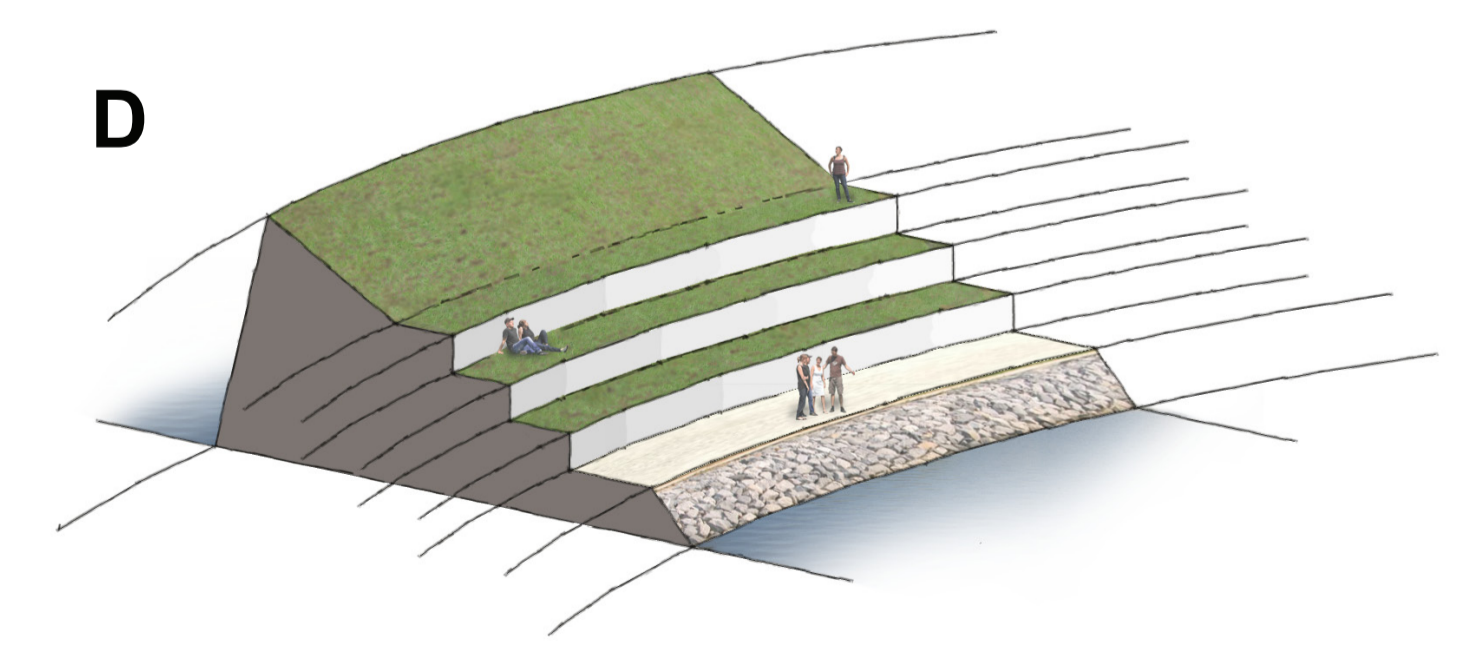
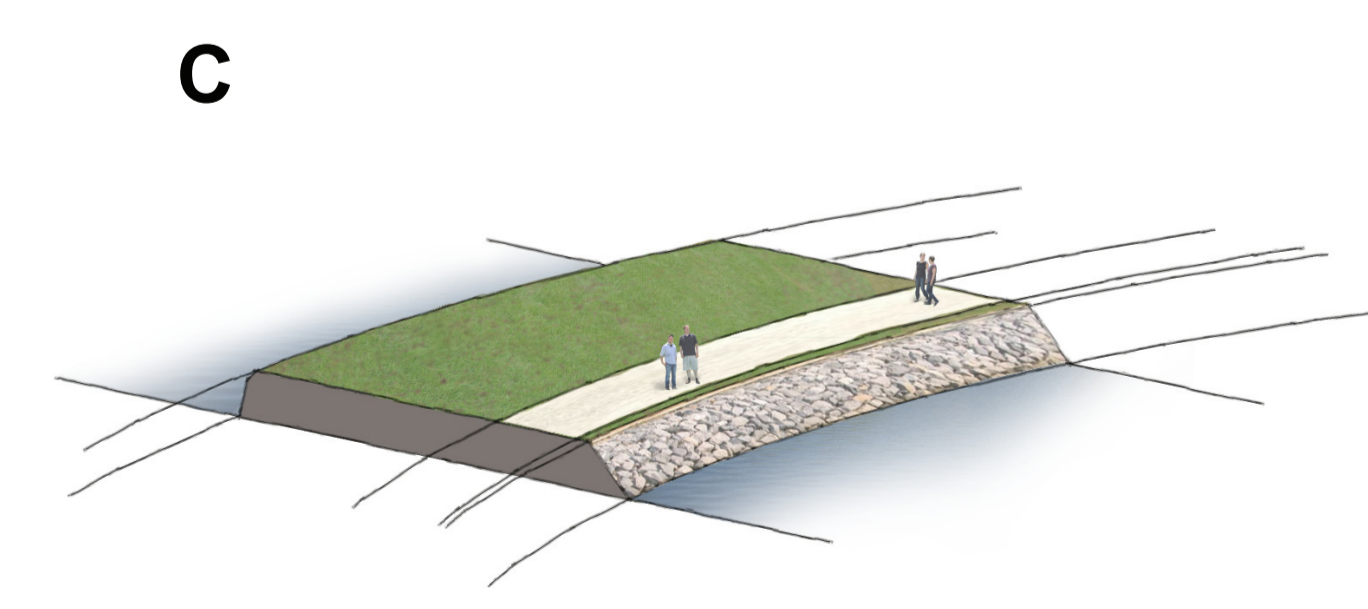
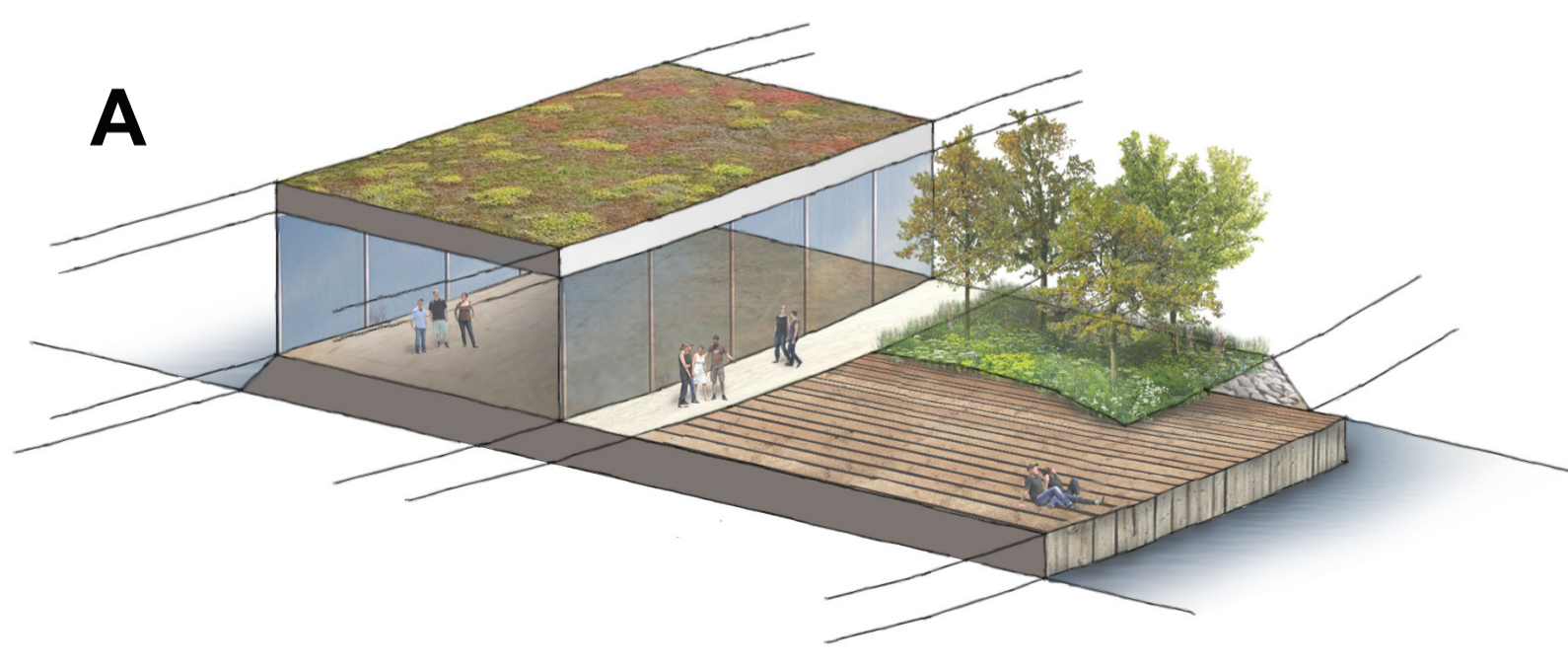
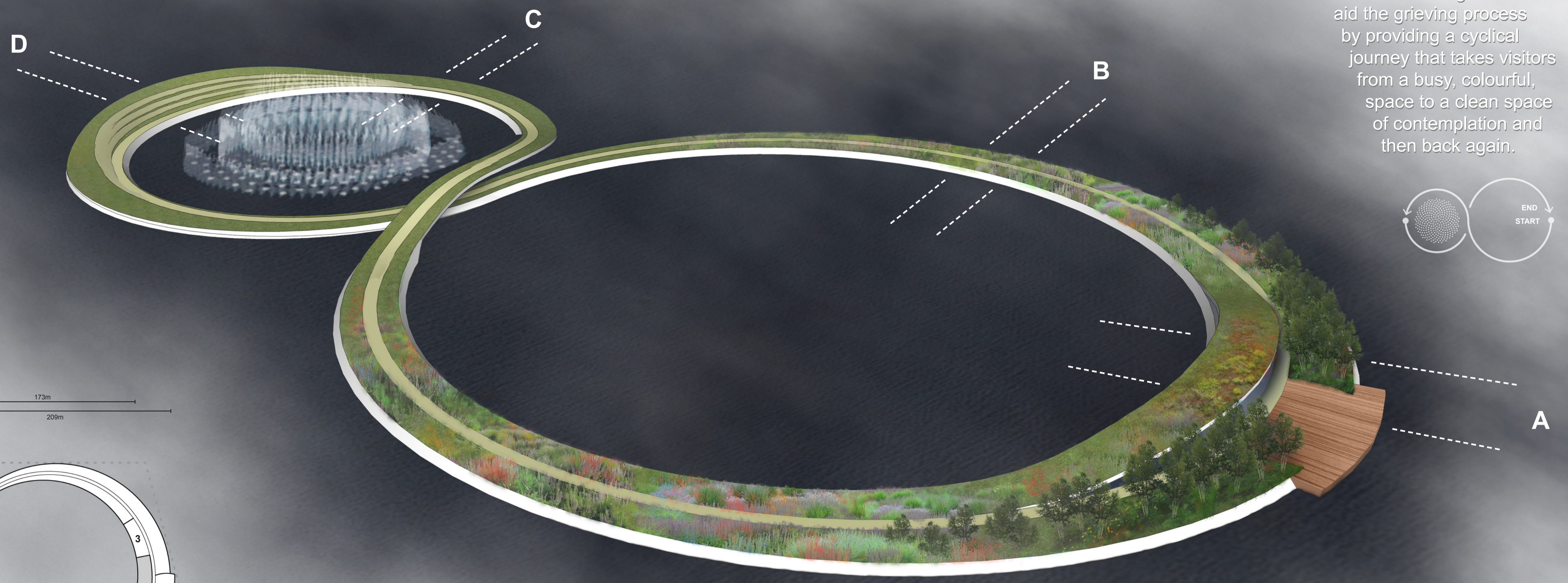

SECTION ALONG PATH

